



SPECIFICATION INFORMATION HOUSE WRAP DIVISION: 7

1.0 PRODUCT NAME

Wraptor® House Wrap

2.0 MANUFACTURER



Insulation Solutions, Inc.
401 Truck Haven Road
East Peoria, IL 61611

Engineering Assistance
Toll Free: 866 698-6562
Fax: 309 698-0065
www.insulationsolutions.com

3.0 PRODUCT DESCRIPTION

3.1 BASIC USE:

Wraptor is a cross-woven micro-perforated, polypropylene house wrap designed to protect exterior wall systems from bulk moisture infiltration.

Wraptor is breathable and extremely tear resistant.

3.2 COMPOSITION & MATERIALS:

Wraptor is a micro-perforated, cross-woven polyethylene material.

3.3 SIZE

Wraptor is manufactured in widths ranging from 3' to 10' in roll lengths of 100' and 150'. Custom roll sizes are available.

3.4 WEIGHT

Wraptor weighs approximately 17.2 lbs. per 1000 sq. ft.

4.0 TECHNICAL DATA

4.1 APPLICABLE STANDARDS

- **ICC-ES EVALUATION REPORT ESR-3468**
- **TAPPI T-460** Air Resistance of Paper
- **TAPPI T-410** Basis Weight
- **ASTM E 96** Standard Test Method for Water Vapor Transmission of Materials
- **ASTM D 882** Standard Test Method for Tensile Properties of Thin Plastic Sheeting
- **ASTM D 1117** Standard Test Method for Evaluating Non-woven Fabrics
- **ASTM D 751** Standard Test Method for Coated Fabrics
- **ASTM E 84** Standard Test Method for Surface Burning Characteristics of Building Materials
- **AATCC 127** Water Penetration Resistance

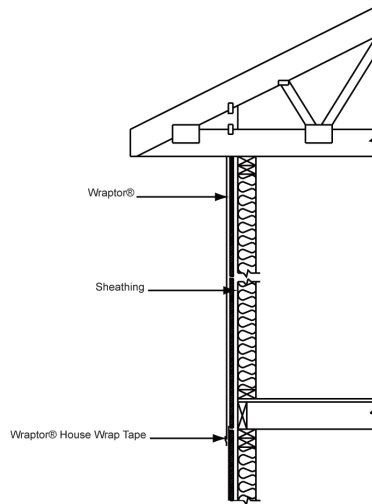

5.0 INSTALLATION

WRAPTOR PLACEMENT

- 5.1 Align bottom edge of roll to the bottom portion of the wall and unroll against the wall sheathing.
- 5.2 Fasten with plastic cap nails, staples or large head nails. When installing over foam sheathing, fasteners should penetrate structural framing at least 1/2".
- 5.3 Overlap all vertical seams a minimum of 6". Horizontal seams should be overlapped a minimum of 8".
- 5.4 All seams, tears and protrusions should be taped with Wraptor House Wrap Tape or other appropriate tape.
- 5.5 For window and door details refer to the Wraptor Installation Guide available from the manufacturer.

PROTECTION

- 5.6 Wraptor should be covered with the exterior cladding as soon as it is practical (maximum 180 days).
- 5.7 When using Wraptor behind stucco, a lathe system should be employed. In moist or humid areas, check local codes for proper moisture control practices. Some areas may require two layers of house wrap and/or an additional drainage plane behind stucco finishes.
- 5.8 Back-priming of wood or other porous siding is recommended before installing over house wrap. (These are very general installation instructions. The Wraptor Installation Guide contains more detailed instructions and is available from the manufacturer. Instructions on architectural or structural drawings should be reviewed and followed as well.)

PROPERTIES	TEST METHOD	WRAPTOR®
Material	N/A	PP Scrim/White
Thickness	N/A	5 mils (Average)
Weight	ASTM D 751	1.92 oz./sq.yd. (+/- 5%)
Tensile Strength	ASTM D 5034	Warp 52 lbs. Fill 29 lbs.
Trapezoidal Tear	ASTM 4533	Warp 30 lbs. Fill 19 lbs.
Water Resistance	ASTM 779	Pass
Water Vapor Transmission	ASTM E 96A	8-9 perms
UV Resistance	AATCC 16 Part 3 Light (100, 200, 300 hrs.)	No degradation or loss of strength > 50% @ 144 hrs.

6.0 AVAILABILITY & COST

Wraprot is sold through construction supply houses and lumberyards across the United States.

Wraprot current cost information can be obtained by calling our corporate sales office at 866-698-6562.

7.0 WARRANTY

To the best of our knowledge, the specification chart on page one lists typical property values and are intended as guides only, not as specification limits.

INSULATION SOLUTIONS INC. MAKES NO WARRANTIES AS TO THE FITNESS FOR A SPECIFIC USE OR MERCHANTABILITY OF PRODUCTS REFERRED TO, NO GUARANTEE OF SATISFACTORY RESULTS FROM RELIANCE UPON CONTAINED INFORMATION OR RECOMMENDATIONS AND DISCLAIMS ALL LIABILITY FOR RESULTING LOSS OR DAMAGE.

8.0 MAINTENANCE

Wraprot requires no maintenance

9.0 TECHNICAL SERVICES

Technical information and detailed test results can be obtained by calling our corporate office at 866-698-6562.

10.0 FILING SYSTEMS

Additional information is available from the manufacturer.

Note: To the best of our knowledge, the specification chart on page one lists typical property values and are intended as guides only, not as specification limits. Insulation Solutions Inc.® makes no warranties as to the fitness for a specific use or merchantability of products referred to, no guarantee of satisfactory results from reliance upon contained information or recommendations and disclaims all liability for resulting loss or damage.

INSULATION SOLUTIONS, INC

[401 Truck Haven Road] [East Peoria, Illinois 61611] [Toll Free: 866.698.6562] [P: 309.698.0062] [F: 309.698.0065]

WWW.INSOLUTIONSOLUTIONS.COM
